

**RAILROAD COMMISSION OF TEXAS
OIL AND GAS DIVISION**

**NOTICE OF
APPLICATION**

Form W-14
05/2004
MIL0205

**APPLICATION TO DISPOSE OF OIL AND GAS WASTE BY INJECTION
INTO A FORMATION NOT PRODUCTIVE OF OIL AND GAS**

1. Operator Name Patton Exploration, Inc. 2. Operator P-5 No. 643730

3. Operator Address: PO Box 3399, Abilene, TX 79604

4. County Fisher 5. RRC District No. 7B

6. Field Name Longworth (Flippen) 7. Field Number 54821500

8. Lease Name Stuart SWD 9. Lease/Gas ID No. _____

10. Well is ±5.8 miles in a SW direction from Roby (center of nearest town). 11. No. acres in lease 160
4,822' FNL & 9,313' FWL, Lge. 305, Gillespie CSL Survey, A-26

12. Legal description of location including distance and direction from survey lines _____

13. Latitude/Longitude, if known (Optional) Lat. 32.663339° Long. -100.4010897° (NAD 83)

14. New Permit: Yes No If no, amendment of Permit No. _____ UIC# _____

15. Reason for amendment: Pressure Volume Interval Commercial Other (explain) _____

16. Well No. 1	17. API No. 42-115-33309	18. Date Drilled To Be Drilled			19. Total Depth 4,500'		20. Plug Date, if re-entry	
Casing	Size	Setting Depths	Hole Size	Casing Weight	Cement Class	Cement Sacks (#)	Top of cement	Top Determined by
21. Surface	10 3/4"	210'	13 1/2"	40.5#		±100	Surface	Circulation
22. Intermediate								
23. Long String	7 5/8"	4,500'	8 3/4"	26#		±700	Surface	Circulation
24. Liner								
25. Other								

26. Depth to base of Deepest Freshwater Zone 200' 27. Multiple completion? Yes No

28. Multistage cement? Yes No If yes, DV Tool Depth: _____ ft. No. Sacks: _____ Top of Cement: _____

29. Bridge Plug Depth: _____ ft. 30. Injection Tubing Size: 3 1/2" in. and Depth 3,720 ft. 31. Packer Depth: 3,730 ft.

32. Cement Squeeze Operations (List all giving interval and number of sacks of cement and cement top and whether Proposed or Complete.):

33. Injection Interval from 3,820 to 4,400 ft. 34. Name of Disposal Formation Crystal Falls, Breckenridge & Swastika

35. Any Oil and Gas Productive Zone within two miles? Yes No If yes, Depth ±3,600 ft. and Reservoir Name Flippen @ ±3,600' & Canyon @ ±5,000'

36. Maximum Daily Injection Volume 20,000 bpd 37. Estimated Average Daily Injection Volume 10,000 bpd

38. Maximum Surface Injection Pressure 1,910 psig 39. Estimated Average Surface Injection Pressure 500 psig

40. Source of Fluids (Formation, depths and types): Produced Saltwater @ ±6,000', Strawn Formation

41. Are fluids from leases other than lease identified in Item 3? Yes No 42. Commercial Disposal Well? Yes No

43. If commercial disposal, will non-hazardous oil and gas waste other than produced water be disposed of? Yes No

44. Type(s) of Injection Fluid: Salt Water Brackish Water Fresh Water CO₂ N₂ Air H₂S
LPG NORM Natural Gas Polymer Other (explain) RCRA Exempt Waste (See Attached)

CERTIFICATE

I declare under penalties prescribed in Sec. 91.143, Texas Natural Resources Code, that I am authorized to make this report, that this report was prepared by me or under my supervision and direction, and that the data and facts stated therein are true, correct, and complete to the best of my knowledge.

Signature Robert Patton Date 2-24-2023
Robert Patton, President weldon@milconinc.com
Name of Person (type or print)
Phone (325) 677-3318 Fax (325) 677-7721

FOR OFFICE USE ONLY REGISTER NO. AMOUNT \$

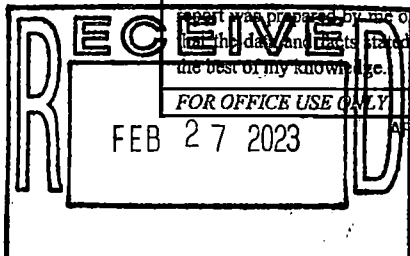

APPLICANT ALSO MUST COMPLY WITH THE INSTRUCTIONS ON THE REVERSE SIDE

NAD 83 SCS' NCTZ GRID BEARINGS AND DISTANCES



8

7

15

14

13

Fisher County Road 414

Fisher County Road 421

Sidney P. Allen's Subdivision of Leagues 304,305,318 and 319 Gillespie County School Land A-26

26

27

28

LOCATION IS 5.8 MILES SOUTHWEST OF ROBY, TX
LOC. IS 187' FSL & 983' FWL OF BLOCK 14,
OF SIDNEY P. ALLEN'S SUBDIVISION OF LEAGUES
304,305,318, AND 319 OF GILLESPIE COUNTY SCHOOL
LAND, ABSTRACT NUMBER 26
LOC. IS 983' FEL & 187' FSL OF THE LEASE
LOC. N-6929561 E-1383507 NAD 83 NCTZ
LOC. X-1107455 Y-374872 NAD 27 NCTZ
LOC. LAT. 32°39'48.02" LONG. -100°24'03.92" NAD 83
LOC. LAT. 32.663339° LONG. -100.4010897° NAD 83
ELEVATION: 2071'

- 1. THE SURVEYOR HAS MADE NO INVESTIGATION OR INDEPENDENT SEARCH FOR LEASE LINES, EASEMENTS OF RECORD, ENCUMBRANCES, RESTRICTIVE CONVEYANTS, OWNERSHIP TITLE EVIDENCE, OR ANY OTHER FACTS THAT A CURRENT TITLE SEARCH MAY DISCLOSE. CONTRACTORS ARE RESPONSIBLE FOR LOCATING ALL EASEMENTS.
- 2. NOTE: FOR SURVEY CONSTRUCTION, CORNER DESCRIPTIONS AND RECORD REFERENCES, SEE SUPPORTING DOCUMENTS IN FILE.
- 3. THE ABOVE SKETCH REPRESENTS THE LOCATION AS STAKED ON THE GROUND AND IS FOR PERMIT PURPOSES ONLY. THE LEASE OUTLINE IS BASED ON RECORD DATA PROVIDED BY THE CLIENT.

Patton Exploration, Inc.
Stuart SWD Lease
#1 Location

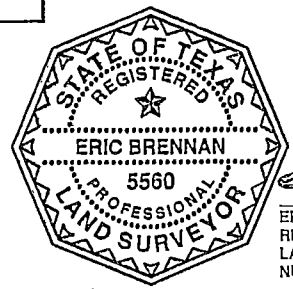

ERIC BRENNAN, TEXAS
REGISTERED PROFESSIONAL
LAND SURVEYOR
NUMBER 5560

OWEN SURVEYING CO.
 FIRM #10069000 WWW.OWENSURVEYING.COM
 110 W. ELLIOTT ST., BRECKENRIDGE, TX 76424
 PHONE (254)559-9898 FAX (254)559-7372 CELL (254)559-0127

LOCATION PLAT: FISHER COUNTY
 DRAWN BY: MD CHECKED BY: EB

Scale 1"=1000'	Date 10/06/2022	Print Number F-67L
-------------------	--------------------	-----------------------

